



MÉNE

TABLE LAMP

Méne celebrates our sense of wonder and awe of the celestial. The shade appears like a lunar apparition, delicately poised on top of a glass stem. Crafted with mouth blown glass, the collection highlights the individual and unique texture of subtly illuminated glass. Méne's rippled form is the result of the studio's continual experimentations with traditional optic glass blowing techniques and innovative engineering. The result is a one of a kind glass texture within every luminaire produced.

AVAILABLE FINISHES

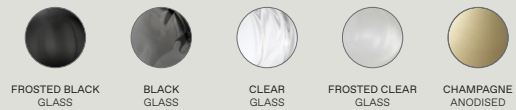

TECHNICAL

MATERIAL	ANODISED ALUMINIUM, GLASS	
LAMPING	230V - 4W AC LED MODULE, 380 LUMEN PER LIGHT SOURCE. 3000K WARM WHITE, DIMMABLE.	
	120V - 4W AC LED MODULE, 380 LUMEN PER LIGHT SOURCE. 3000K WARM WHITE, DIMMABLE.	
	ALL US AND CANADIAN ORDERS COME SUPPLIED WITH 120V COMPONENTRY CERTIFIED FOR USE IN THESE REGIONS.	
LED LIFESPAN	50,000 HRS	
CONTROL	THE MÉNE TABLE LAMP COMES SUPPLIED WITH A IN-LINE PUSH DIMMER SWITCH. DIMMING RANGE 10 - 100%	
IP RATING	IP20 - FOR INDOOR USE ONLY	
CERTIFICATION	AU/NZ	AS/NZS 60598.1, 60598.2.4
	EU	EN 60598.1, 60598.2.4
	US/CAN	ETL/UL CERTIFICATION PENDING

CORD	BLACK CLOTH WITH IN-LINE PUSH-DIM SWITCH AND AS/NZS STANDARD PLUG.		
	USA/CAN NEMA-1, 2-PIN PLUG SUPPLIED FOR NORTH AMERICA/CANADA.		
	LONGER LENGTHS AVAILABLE UPON REQUEST.		
PRODUCT CODES SKU	EG. ML-G-FCL-A-CHM		
	MÈNE TABLE LAMP IN FROSTED CLEAR GLASS WITH A CHAMPAGNE ANODISED BODY		
	ML-G-XXX-A-CHM	MENÉ TABLE LAMP	
FINISHES	GLASS	FROSTED BLACK (G-FBK)	
		BLACK (G-BLK)	
		CLEAR (G-CLR)	
		FROSTED CLEAR (G-FCL)	
	BODY	CHAMPAGNE ANODISED (A-CHM)	
WEIGHT	11KG / 24LB		
PACKAGING	L 53CM W 53CM H 53CM / L 1'9" W 1'9" H 1'9"		
PACKAGING WEIGHT	13KG / 29LB		

DIMENSIONS

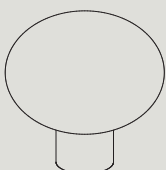

ML
Ø440 H 430
Ø1'5" H 1'5"